

LEGEND

BC	EXISTING BACK OF CURB ELEVATION
*875.41	EXISTING EDGE OF PAVEMENT ELEVATION
EP	
*875.09	
C	EXISTING CONCRETE ELEVATION
*875.12	
FL	EXISTING FLOWLINE ELEVATION
*875.01	
TB	EXISTING TOP OF BERM ELEVATION
*876.08	
TS	EXISTING TOE OF SLOPE ELEVATION
*875.14	
P	EXISTING PAVEMENT ELEVATION
*875.18	
NG	EXISTING GROUND ELEVATION
*874.82	
RBC	EXISTING ROLL CURB ELEVATION
*874.24	
FF	EXISTING FINISH FLOOR ELEVATION
*876.99	
SW	EXISTING SIDEWALK ELEVATION
*876.78	
HW	EXISTING HEADWALL ELEVATION
*878.38	
DG	DECOMPOSED GRANITE ELEVATION
*877.85	
WD	EXISTING WOOD STEP ELEVATION
*879.89	
LC	EXISTING LANDSCAPE CURB ELEVATION
*877.27	
UD	EXISTING UNDER DRAIN ELEVATION
*876.08	
RR	EXISTING RIP-RAP ELEVATION
*874.38	
DR	EXISTING DIRT ROAD ELEVATION
*877.04	
IMH	EXISTING IRRIGATION MANHOLE
SSMH	EXISTING SANITARY SEWER MANHOLE
SSCO	EXISTING SANITARY SEWER CLEANOUT
EC	EXISTING ELECTRIC CABINET
ET	EXISTING ELECTRIC TRANSFORMER
AC	EXISTING AIR CONDITIONING UNIT
RD	EXISTING ROOF DRAIN
ER	EXISTING ELECTRIC RISER
EBB	EXISTING ELECTRIC BREAKER BOX
	EXISTING PASTURE VALVE
ICV	EXISTING IRRIGATION CONTROL VALVE
PST	EXISTING POST
PB	EXISTING PIPE BOLLARD
CBOX	EXISTING CBOX
RP	EXISTING RISER PIPE
WR	EXISTING WATER RISER
GR	EXISTING GAS RISER
GM	EXISTING GAS METER
GI	EXISTING GREASE INTERCEPTER
DCV	EXISTING DOUBLE CHECK VALVE
BFP	EXISTING BACK FLOW PREVENTER
PP	EXISTING POWER POLE
IB	EXISTING I-BEAM
SIGN	EXISTING SIGN
BB	EXISTING BUMPER BLOCK
JB	EXISTING JUNCTION BOX
CB	EXISTING CATCH BASIN
FH	EXISTING FIRE HYDRANT
SDCO	EXISTING STORM DRAIN CLEANOUT
CR	EXISTING COMMUNICATION RISER
SS	EXISTING SAFETY SWITCH
DL	EXISTING DRIPLINE
CLM	EXISTING COLUMN
GW	EXISTING GUY WIRE
LPL	EXISTING LIGHT POLE
WMB	EXISTING WATER METER BOX
WV	EXISTING WATER VALVE
FDC	EXISTING FIRE DEPARTMENT CONNECTION
HB	EXISTING HOSE BIB
	EXISTING SHUTOFF VALVE
C=77.00	PROPOSED CONCRETE ELEVATION
G=75.37	PROPOSED GUTTER ELEVATION
F=75.31	PROPOSED FLOWLINE ELEVATION
TC=77.10	PROPOSED TOP OF CURB ELEVATION
P=76.60	PROPOSED PAVEMENT ELEVATION
G.B.	PROPOSED GRADE BREAK
S=0.3%	PROPOSED FLOW DIRECTION

GENERAL NOTES (MARICOPA COUNTY):

- ALL WORK SHALL CONFORM TO THE MOST CURRENT UNIFORM STANDARD SPECIFICATIONS FOR PUBLIC WORKS CONSTRUCTION PUBLISHED BY THE MARICOPA ASSOCIATION OF GOVERNMENTS (MAG), TOGETHER WITH THE MCDOT SUPPLEMENT TO THE MAG STANDARD SPECIFICATIONS AND THE PROJECT SPECIAL PROVISIONS. ALL WORK MUST ALSO COMPLY WITH RESOLUTION 2001-01 - MARICOPA COUNTY RESOLUTION FOR PERMITS TO WORK IN DEDICATED RIGHT-OF-WAY AND RESOLUTION 2001-02 MARICOPA COUNTY RESOLUTION FOR STREET IMPROVEMENTS, INSTALLATION OF UTILITIES AND TRAFFIC CONTROL. ANY EXCEPTIONS MUST RECEIVE EXPLICIT APPROVAL FROM MCDOT AND SHALL BE IDENTIFIED ON THE PLANS AS HAVING EXPLICIT APPROVAL FROM MCDOT.
- THE ENGINEERING DESIGNS ON THESE PLANS ARE ONLY APPROVED BY MCDOT IN CONCEPT AND NOT IN DETAIL. CONSTRUCTION QUANTITIES ON THESE PLANS ARE NOT VERIFIED BY MCDOT. APPROVAL OF THESE PLANS ARE FOR PERMIT PURPOSES ONLY AND SHALL NOT PREVENT MCDOT FROM REQUIRING CORRECTION OF ERRORS IN THE PLANS WHERE SUCH ERRORS ARE SUBSEQUENTLY FOUND TO BE IN VIOLATION OF ANY LAW, ORDINANCE, HEALTH, SAFETY, MCDOT ROADWAY DESIGN MANUAL, OR OTHER DESIGN ISSUES.
- AN APPROVED SET OF PLANS SHALL BE ON THE SITE DURING CONSTRUCTION AND AVAILABLE TO MCDOT AND OTHER INSPECTORS.
- ALL BOX CULVERTS CONSTRUCTED IN THE PUBLIC RIGHT-OF-WAY SHALL COMPLY WITH ARIZONA DEPARTMENT OF TRANSPORTATION (ADOT) LATEST DESIGN SPECIFICATIONS AND STANDARDS. MINIMUM CLEAR HEIGHT OF BOX CULVERT SHALL BE 4 FEET.
- CONTRACTOR TO OBTAIN NECESSARY MCDOT PERMITS PRIOR TO CONSTRUCTION WITHIN COUNTY RIGHT-OF-WAY, AND ALL NECESSARY PERMITS FROM LOCAL GOVERNMENTS FOR WORK WITHIN THEIR JURISDICTION.
- CONTRACTOR SHALL NOTIFY THE MCDOT INSPECTION DEPT. AT LEAST 24 HOURS IN ADVANCE OF ANY CONSTRUCTION AT (602) 506-8606.
- CONTRACTOR PERFORMING CONSTRUCTION OR EXCAVATING OPERATIONS IS RESPONSIBLE FOR LOCATING AND RELOCATING ALL UTILITIES IN CONFLICT OR WITHIN THE CLEAR ZONE, AT NO EXPENSE TO MARICOPA COUNTY. THE CONTRACTOR SHALL CONTACT "BLUE STAKE" AT (602) 263-1100 PRIOR TO BEGINNING CONSTRUCTION.
- THE CONTRACTOR IS RESPONSIBLE FOR OBTAINING ANY REQUIRED PERMITS FOR EARTH MOVING FROM MARICOPA COUNTY AIR QUALITY DEPARTMENT'S DUST COMPLIANCE DIVISION (602) 506-6010 PRIOR TO CONDUCTING EXCAVATION OPERATIONS. A COPY OF THE PERMIT AND DUST CONTROL PLAN SHALL BE SUBMITTED TO THE COUNTY ENGINEER PRIOR TO COMMENCEMENT OF ANY EARTHMOVING ACTIVITIES.
- PRIOR TO CONDUCTING EXCAVATION OPERATIONS, THE CONTRACTOR SHALL OBTAIN FROM THE ARIZONA STATE HISTORICAL PRESERVATION OFFICER (602) 542-4009, RECOMMENDATIONS REGARDING THE NEED FOR CULTURAL RESOURCES (ARCHAEOLOGICAL) CLEARANCE. ALL DISCOVERIES OF HUMAN REMAINS, CULTURAL ARTIFACTS, OR PALEONTOLOGICAL REMAINS SHALL BE REPORTED TO THE ARIZONA STATE MUSEUM AND MCDOT. UPON DISCOVERY, CONTRACTOR SHALL CEASE OPERATIONS IN THE VICINITY OF THE FIND AND PROTECT THE DISCOVERY AREA FROM FURTHER DISTURBANCE UNTIL THE FIND CAN BE PROFESSIONALLY INVESTIGATED BY THE ARIZONA STATE MUSEUM AND MCDOT.
- EXCEPT UNDER EMERGENCY CONDITIONS, ROADS SHALL NOT BE CLOSED FOR CONSTRUCTION ACTIVITY UNLESS PRIOR APPROVAL IS OBTAINED FROM THE MCDOT TRANSPORTATION DIRECTOR OR HIS REPRESENTATIVE.
- PRIOR TO MOVING OR DESTROYING PROTECTED NATIVE PLANT SPECIES, THE CONTRACTOR SHALL FILE A FORMAL NOTICE OF INTENT WITH THE ARIZONA DEPARTMENT OF AGRICULTURE NATIVE PLANTS (602) 542-6408.
- PRIOR TO INSTALLATION OF CURB, GUTTER, SIDEWALK, BASE COURSE AND WEARING SURFACE, SUBMIT SOIL TEST(S) OF SUB-GRADE AND REVISED PAVEMENT DESIGN/CALCULATIONS TO MCDOT FOR REVIEW AND APPROVAL. IF SUB-GRADE STABILIZATION IS REQUIRED, THE AREA STABILIZED SHALL BE FROM BACK OF SIDEWALK TO BACK OF SIDEWALK AND MATCH THE STABILIZATION DEPTH OF THE PAVEMENT STRUCTURE.
- ASPHALT MIX DESIGN SHALL BE SUBMITTED TO MCDOT A MINIMUM OF 48 HOURS PRIOR TO PLACING ANY ASPHALT COURSES. (TRENCH WORK EXCLUDED.) ALL PAVED TURNOUTS SHALL HAVE THE SAME ASPHALT AND BASE REQUIREMENTS AS THE ADJACENT ROADWAY UNLESS NOTED OTHERWISE.
- ALL COMPACTION AND BACKFILL WITHIN COUNTY RIGHT-OF-WAY SHALL CONFORM TO THE MCDOT SUPPLEMENT TO MAG SPECIFICATIONS. BACKFILL UNDER EXISTING PAVEMENT, CURB AND GUTTER OR WITHIN TWO FEET (2') OR LESS FROM THE EDGE OF PAVEMENT SHALL CONSIST OF ONE-HALF (1/2) SACK CLSM.
- ALL STRUCTURES, SUCH AS MANHOLES, VALVE BOX & COVERS, AND MONITORING WELLS MUST BE MARKED WITH AT LEAST TWO REFLECTIVE YELLOW FLEX POSTS WHEN STRUCTURES ARE LOCATED OUTSIDE THE TRAVELED WAY AND WITHIN THE RIGHT-OF-WAY, (APPLIES ONLY WHEN THERE IS NO CURB.)
- ANY SAW CUT ALONG EXISTING ROADWAY EDGE WHICH REMOVES THE EDGE OF THE ROADWAY SHALL BE A MINIMUM OF 1' FROM THE EDGE OF THE EXISTING ROADWAY. THE CUT DISTANCE MAY BE GREATER, BASED ON PAVEMENT CONDITIONS OR ROADWAY ELEVATIONS BUT SHALL NOT BE LOCATED WITHIN A LANE WHEEL PATH, AND IF NEEDED SHALL BE IN HALF LANE INCREMENTS.
- ALL EXISTING PAVEMENT MARKING, TRAFFIC SIGNS AND SIGNAL EQUIPMENT THAT NEEDS TO BE REMOVED, REPLACED, RELOCATED OR REPAIRED BECAUSE OF CONTRACTOR'S WORK WILL BE DONE BY THE CONTRACTOR AT HIS EXPENSE. ALL SALVAGED SIGNS SHALL BE DELIVERED TO THE TRAFFIC OPS BUILDING AT 2909 W. DURANGO ST. ARRANGEMENTS CAN BE MADE FOR DELIVERY BY CALLING (602) 506-8662. ALL NEW STREET NAME SIGNS SHALL BE PROVIDED AND INSTALLED BY PERMITTEE AT NO EXPENSE TO MARICOPA COUNTY.
- PAVEMENT MARKING, SIGNING AND SIGNAL WORK WILL BE INSPECTED AND SHALL MEET COUNTY STANDARDS BEFORE RELEASE OF BOND.
- THE CONTRACTOR SHALL RESTORE ALL DISTURBED AREAS WITHIN THE RIGHT-OF-WAY TO A CONDITION EQUAL TO OR BETTER THAN EXISTING IMPROVEMENTS PER MAG 107.9. DISPOSAL OF ALL WASTE MATERIAL WILL BE THE RESPONSIBILITY OF THE CONTRACTOR.

	PROPOSED CONCRETE SIDEWALK
	PROPOSED A.C. PAVEMENT (4" A.C. (3/4") OVER 7" A.B.C. OVER COMPACTED SUBGRADE

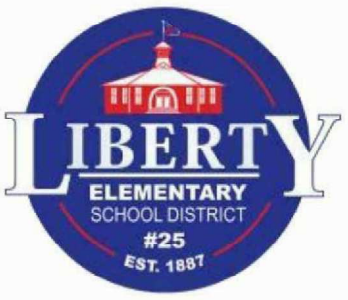
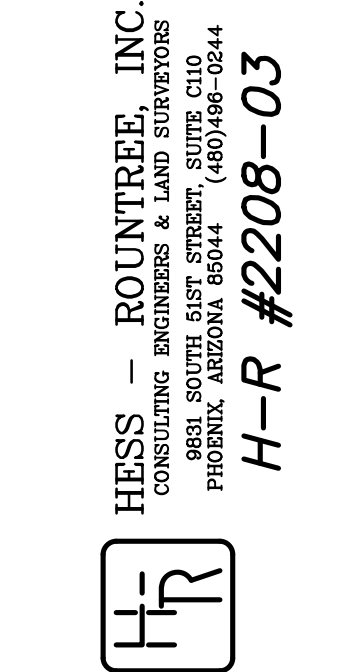
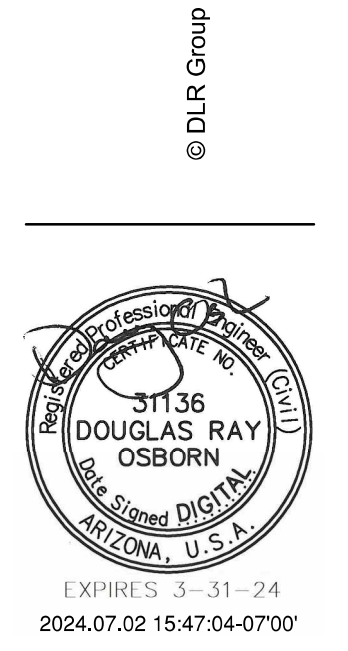
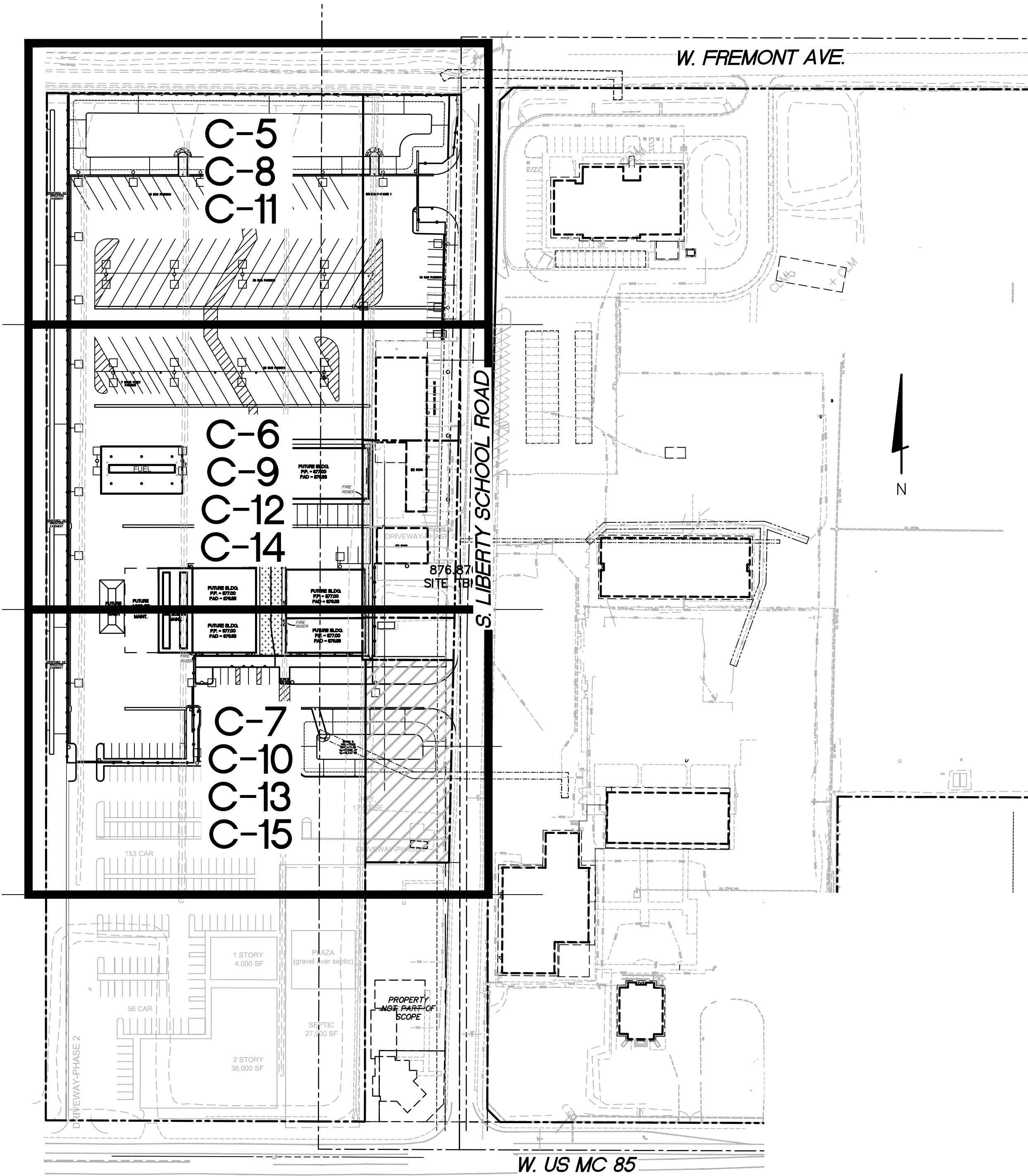

Liberty Transportation Center

Permit/GMP Documents  
07.02.24  
REVISIONS  
ASI 01 07/01/24 MARICOPA CO COMMENTS

30-22131-01  
NOTES, LEGEND AND KEYMAP SHEET





Autodesk Docs/30-22131-01 Liberty ESD Transportation Facility/30-22131-01\_Liberty ESD Transportation Site\_AR\_2022.rvt  
7/8/2024 11:23:46 PM

1

2

3

4

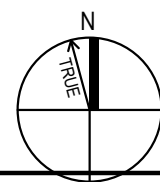
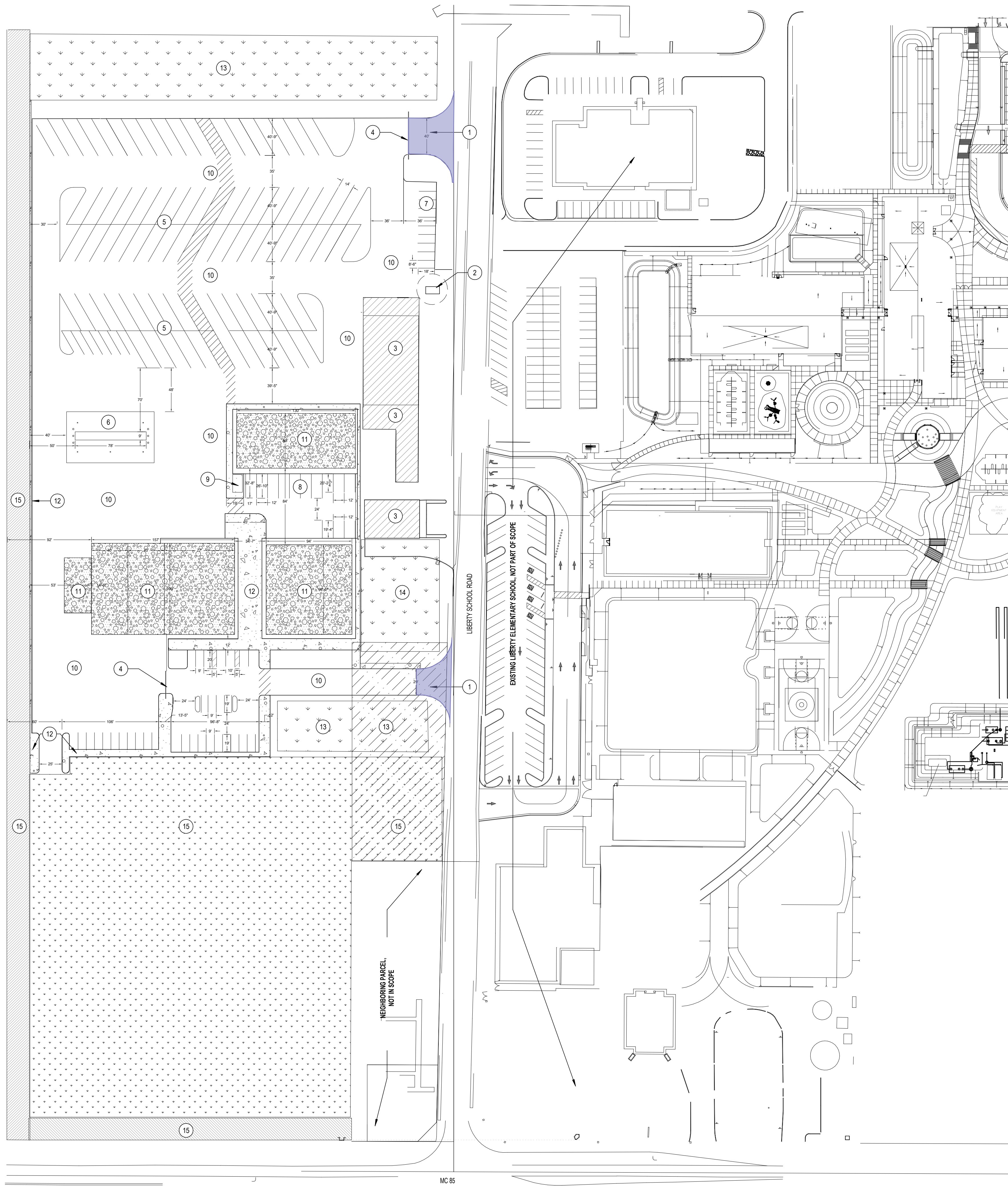

## Overall Site Plan

SCALE: 1" = 60'-0"

## SITE SYMBOLS

	PROPERTY LINE
	LOT LINE
	EASMENT LINE
	BUILDING LINE, EXISTING
	STREET CENTERLINE

## SITE LEGEND

	RETENTION AREA, SEE CIVIL
	EXISTING BUILDINGS TO REMAIN
	FUTURE BUILDING PAD LOCATION, SEE CIVIL
	CITY OF BUCKEYE, JURISDICTION

## # SHEET NOTES

- 1 DRIVEWAY & CURB CUT, SEE CIVIL
- 2 UNDERGROUND FUEL TANKS TO BE REMOVED THROUGH ADEQ'S TANK SITE REMOVAL PROGRAM.
- 3 EXISTING DISTRICT BUILDING TO REMAIN, NO WORK
- 4 ELECTRIC SLIDING METAL GATE, REFER TO CIVIL AND ELECTRICAL DRAWINGS.
- 5 BUS PARKING STRIPING, SEE CIVIL
- 6 ABOVE GROUND FUELING TANK AND CANOPY, SEE DEFERRED SUBMITTALS ON SHEET G0.1
- 7 VEHICLE PARKING, SEE CIVIL
- 8 WHITE FLEET PARKING, SEE CIVIL
- 9 ELECTRICAL SERVICE ENTRY, SEE ELECTRICAL
- 10 ASPHALT PAVING, SEE CIVIL
- 11 GRAVEL PAD, SEE CIVIL
- 12 CONCRETE SIDE CURB / SIDEWALK, SEE CIVIL
- 13 RETENTION, SEE CIVIL
- 14 SEPTIC, SEE DEFERRED SUBMITTALS ON SHEET G0.1
- 15 NO WORK THIS AREA



## Liberty Transportation Center

Liberty Elementary School District  
Liberty School Road and MC85

Construction Documents / Permit Set  
04.04.24  
REVISIONS  
AS1.01 07/01/24 MARICOPA CO. COMMENTS

30-22131-01

ARCHITECTURAL  
SITE PLAN

AS1.1



GRADING AND DRAINAGE CONSTRUCTION NOTES:

- 1

INSTALL A.C. PAVEMENT (3" A.C. (1/2 INCH) OVER 8" A.B.C. OVER COMPACTED SUBGRADE).
- 2

INSTALL CONCRETE SINGLE CURB (MAG STANDARD DETAIL NO. 222, TYPE 'A').
- 3

INSTALL CONCRETE VERTICAL CURB AND GUTTER (MAG STANDARD DETAIL NO. 220-1, TYPE A).
- 4

INSTALL CONCRETE SIDEWALK (MAG STANDARD DETAIL NO. 230). SEE LANDSCAPE DRAWINGS FOR SCORING AND FINISH.
- 5

DECOMPOSED GRANITE AT SIDEWALKS WITHIN 10' OF THE BUILDING SHALL BE FLUSH WITH THE SIDEWALK TO PREVENT WATER FROM PONDING WITH 10' OF THE BUILDING.
- 6

PAINT STRIPE PARKING LOT TO THE ALIGNMENTS INDICATED INCLUDING ALL DIRECTIONAL ARROWS, CROSSWALKS, HANDICAP PARKING SYMBOLS, ETC.
- 7

CONSTRUCT CONCRETE VALLEY GUTTER (MAG STANDARD DETAIL NO. 240, MODIFIED TO BE 3" WIDE).
- 8

SITE FENCING AND GATES. SEE LANDSCAPE DRAWINGS FOR DETAILS.
- 9

INSTALL CONCRETE SPLASHPAD (SEE DETAIL SHEET C-3).
- 10

INSTALL PIPE BOLLARD (MAG STANDARD DETAIL NO. 140, TYPE I).
- 11

INSTALL SIDEWALK RAMP TYPE A (SEE DETAIL ON SHEET C-3).
- 12

STRAIGHT GRADE PLANTERS TO HAVE FINISH GRADE 1" BELOW TOP OF CURB (TYPICAL).
- 13

INSTALL THICKENED PAVEMENT EDGE (MAG STANDARD DETAIL NO. 201, B).
- 14

INSTALL HANDICAP PARKING SIGN PER CITY OF BUCKEYE AND ADA REQUIREMENTS. POST AND BASE PER MAG STANDARD DETAIL NO. 131, TYPE 'C'. TOP OF SIGN SHALL BE 6' ABOVE GRADE. TYPICAL AT EACH HANDICAP SPACE.
- 15

INSTALL CURB TERMINATION (MAG STANDARD DETAIL NO. 222, MODIFIED FOR CONCRETE CURB AND GUTTER WHERE INDICATED).
- 16

MATCH EXISTING GRADE.
- 17

STRAIGHT GRADE FROM 2" BELOW TOP OF CURB AT A MAXIMUM OF 5:1 SLOPE TO MATCH INTO EXISTING GRADE.

- 18

STRAIGHT GRADE FROM 6" BELOW TOP OF CURB AT A MAXIMUM OF 5:1 SLOPE TO MATCH INTO EXISTING GRADE.
- 19

STABILIZED DECOMPOSED GRANITE (SEE LANDSCAPE PLANS FOR DETAILS).
- 20

FUEL STATION BY OTHERS.
- 21

PROTECT EXISTING PAVEMENT EDGE. ANY SAWCUT PAVEMENT SHALL BE TRIMMED TO A CLEAN EDGE, BUT ANY THICKENED EDGE SHALL NOT BE REMOVED.
- 22

CONSTRUCT PAVED TURNOUT (PER MAG STANDARD DETAIL NO. 205, TYPE A).
- 23

INSTALL A.C. PAVEMENT (2" A.C. (1/2 INCH) OVER 8" A.B.C. OVER COMPACTED SUBGRADE)

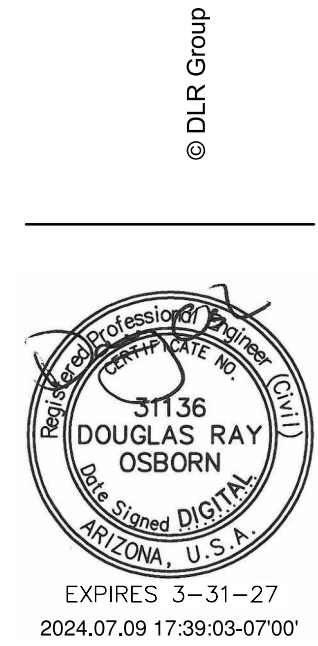
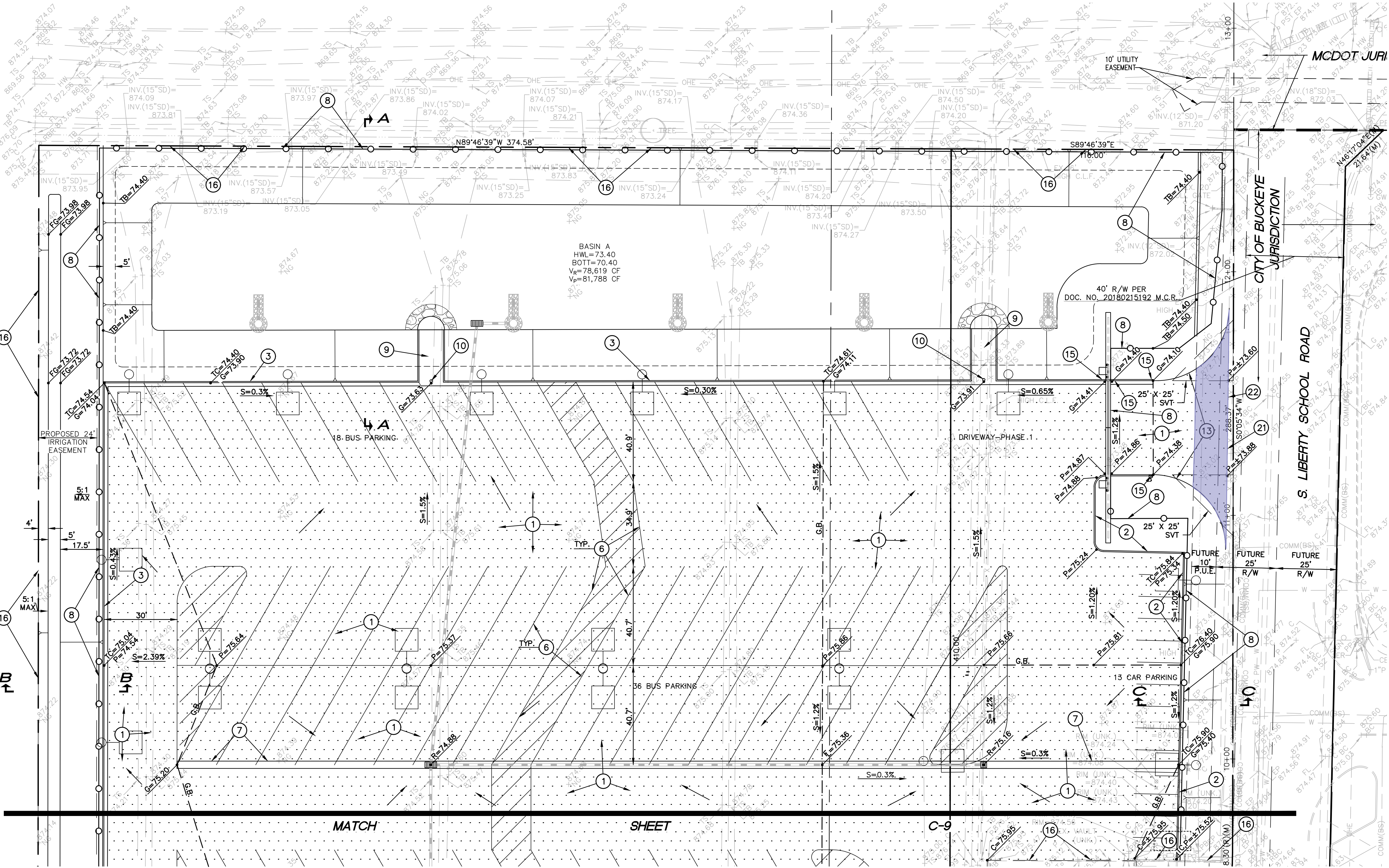

HPSS - ROUNTREE, INC.  
CONSULTING ENGINEERS & LAND SURVEYORS  
9831 SOUTH 61ST STREET, SUITE C10  
PHOENIX, ARIZONA 85044  
H-R #2208-03

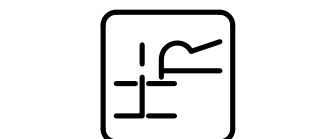

Liberty Transportation Center

Permit/GMP Documents  
07.02.24  
REVISIONS  
ASI 01 07/01/24 MARICOPA CO COMMENTS

30-22131-01  
GRADING AND DRAINAGE PLAN









Autodesk Docs:\30-22131-01 Liberty ESD Transportation Facility\30-22131-01\_Liberty ESD Transportation Site\_AR\_2022.rvt  
1/30/2024 11:27:35 AM

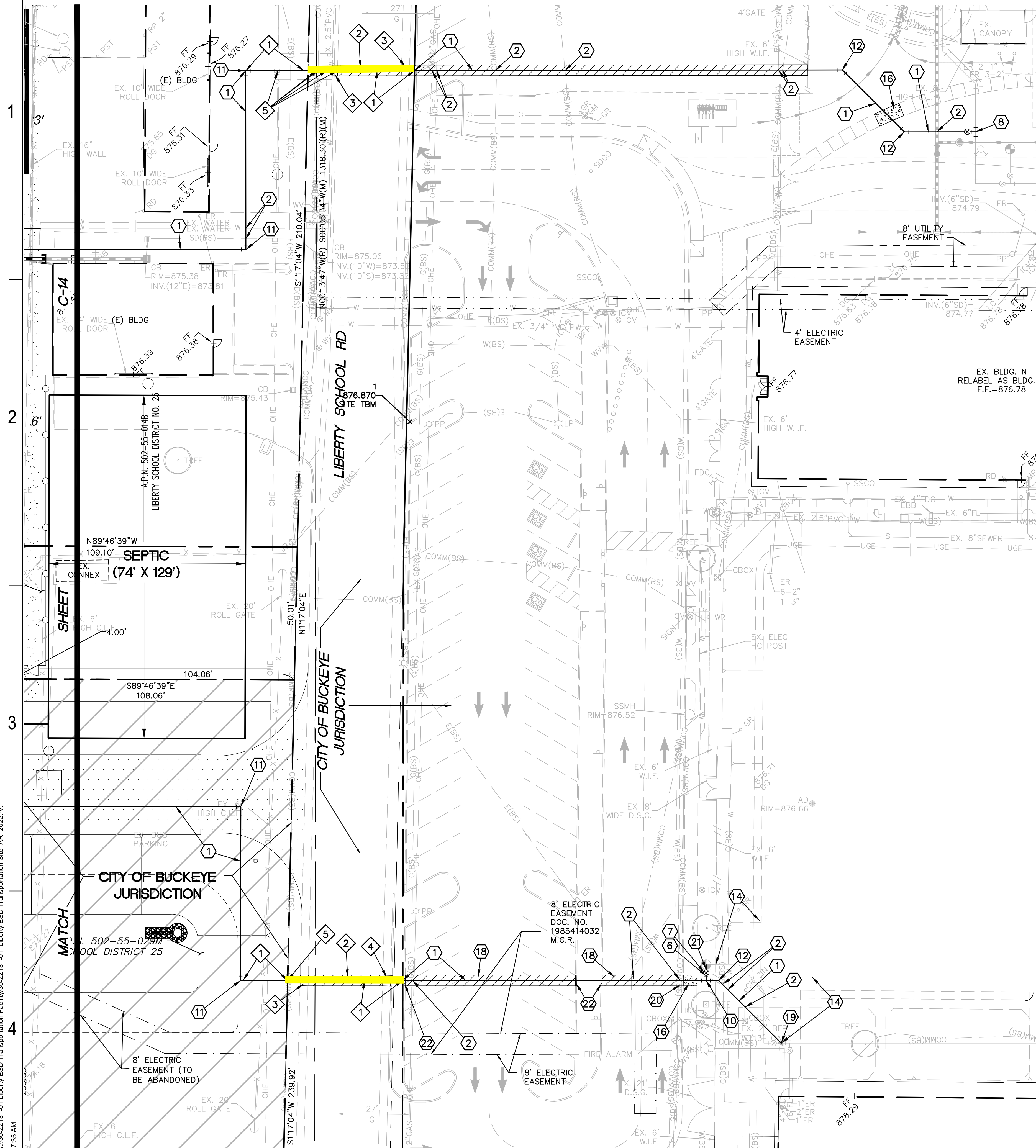

### PRIVATE SANITARY SEWER LINE CONSTRUCTION NOTES:

- 1 INSTALL SEWER CLEANOUT (SEE DETAIL ON SHEET C-3).
- 2 CONNECT TO BUILDING SEWER LINE WITH NECESSARY AND APPROPRIATE FITTINGS. SEE PLUMBING PLANS FOR EXACT LOCATION AND CONTINUATION.
- 3 INSTALL 6" P.V.C. SEWER LINE (ASTM D3034, SDR-35).
- 4 INSTALL 4" P.V.C. SEWER LINE (ASTM D3034, SDR-35)
- 5 INSTALL SERVICE CONNECTION (MAG STANDARD DETAIL NO. 440-1).

### PRIVATE DOMESTIC WATER LINE CONSTRUCTION NOTES:

- 1 INSTALL 2-1/2" SCHEDULE 40 P.V.C. WATER LINE WITH SCHEDULE 80, TEES, FITTINGS, CONCRETE THRUST BLOCKS, ETC.
- 2 CONNECT TO EXISTING 2-1/2" WATER LINE WITH NECESSARY AND APPROPRIATE FITTINGS. FIELD VERIFY ELEVATION AND LOCATION PRIOR TO CONSTRUCTION.
- 3 INSTALL 2-1/2" GATE VALVE WITH VALVE BOX AND COVER (MAG STANDARD DETAIL NO. 391-2).
- 4 CONNECT TO BUILDING DOMESTIC WATER LINE WITH NECESSARY AND APPROPRIATE FITTINGS. SEE PLUMBING PLANS FOR CONTINUATION.
- 5 INSTALL 4" P.V.C. (RING TITE, CLASS 200) WATER LINE WITH CAST IRON BENDS, FITTINGS AND CONCRETE THRUST BLOCKS.
- 6 INSTALL 4" GATE VALVE WITH VALVE BOX AND COVER (MAG STANDARD DETAIL NO. 391-2).
- 7 FIELD VERIFY ELEVATION AND LOCATION OF EXISTING ELECTRICAL, FLOOD IRRIGATION AND WATER LINES PRIOR TO CONSTRUCTION. PROTECT FROM DAMAGE.
- 8 CAP WATER LINE WITH A WATERTIGHT CAP AND THRUST BLOCK.
- 9 INSTALL 4" TO 2-1/2" REDUCER.

### OFFSITE WATER LINE CONSTRUCTION NOTES:

- 1 INSTALL 8" DUCTILE IRON (PRESSURE CLASS 350) WATER LINE. TRENCHING SHALL BE PER CITY OF BUCKEYE STANDARD DETAIL NO. 31380.
- 2 SAWCUT, REMOVE AND REPLACE EXISTING A.C. PAVEMENT (MAG STANDARD DETAIL NO. 200, T-TOP AND BUCKEYE STANDARD DETAIL NO. 31380. ALL TRENCHES WITHIN THE RIGHT OF WAY SHALL BE BACKFILLED WITH 1/2 SACK CLSM PER MAG SPECIFICATION SECTION 601.
- 3 SAWCUT, REMOVE AND REPLACE EXISTING CONCRETE RIBBON CURB TO THE NEAREST JOINT (MAG STANDARD DETAIL NO. 220-1, TYPE B).
- 4 SAWCUT, REMOVE AND REPLACE EXISTING CONCRETE VERTICAL CURB AND GUTTER TO THE NEAREST JOINT (MAG STANDARD DETAIL NO. 220-1, TYPE A).
- 5 POTHOLE AND FIELD VERIFY ELEVATION AND LOCATION OF EXISTING UTILITIES PRIOR TO CONSTRUCTION. PROTECT FROM DAMAGE. A MINIMUM 1' OF VERTICAL CLEARANCE IS NEEDED BETWEEN THE BOTTOM OF WATER LINE AND TOP OF ALL EXISTING WET UTILITIES. A MINIMUM 1' OF VERTICAL CLEARANCE IS NEEDED FROM ALL DRY UTILITIES.

### PRIVATE FIRE LINE THRUST BLOCK NOTE:

ALL THRUST BLOCKS SHALL BE CONSTRUCTED OF M.A.G. CLASS C CONCRETE. FOR ALL PRIVATE FIRE LINE THRUST BLOCKS THE AREA OF BEARING FACE SHALL BE PER NFPA-24. THE FOLLOWING CHART IS FROM NFPA-24.

PIPE SIZE (IN.)	90° BEND (SQ.FT.)	45° BEND (SQ.FT.)	TEES, PLUGS, CAPS AND HYDRANTS (SQ.FT.)
4	2	2	2
6	5	3	4
8	8	5	6
10	13	7	9
12	18	10	13
14	25	14	18
16	32	18	23

### UNDERGROUND UTILITY TRACER WIRE NOTE:

ALL NEW UNDERGROUND FACILITIES/UTILITIES SHALL BE INSTALLED WITH A DETECTABLE UNDERGROUND LOCATION DEVICE. INSTALL A #18 INSULATED TRACER WIRE SECURELY ATTACHED TO EACH UTILITY AT 8'-FEET ON CENTER. 12" OF TRACER WIRE SHALL BE ACCESSIBLE ABOVE GRADE AT THE TERMINATION AND SHALL BE SECURELY ATTACHED AT THAT POINT. THE CONTRACTOR SHALL VERIFY WHICH COLOR TO USE FOR STORM DRAIN, WATER, SEWER, ETC., WITH THE CITY OF BUCKEYE AND APPROPRIATE UTILITY COMPANIES. THE CONTRACTOR SHALL INCLUDE ALL COSTS ASSOCIATED WITH THIS REQUIREMENT IN THEIR BID.

### NOTE:

ALL NEW UNDERGROUND UTILITIES (WATER, SEWER, FIRE AND STORM DRAIN LINES) SHALL BE BEDDED WITH A.B.C., PER MAG SECTION 702, FROM 4" (MIN.) BELOW THE BOTTOM OF THE PIPE TO 12" (MIN.) ABOVE THE TOP OF THE PIPE.

### PRIVATE FIRE LINE CONSTRUCTION NOTES:

- 1 INSTALL 8" P.V.C. (AWWA C-900, DR-18, PRESSURE CLASS 235) WATER LINE WITH DUCTILE IRON BENDS, FITTINGS, CONCRETE THRUST BLOCKS, ETC.
- 2 POTHOLE AND FIELD VERIFY ELEVATION AND LOCATION OF EXISTING UTILITIES PRIOR TO CONSTRUCTION. PROTECT FROM DAMAGE. A MINIMUM 1' OF VERTICAL CLEARANCE IS NEEDED BETWEEN THE BOTTOM OF WATER LINE AND TOP OF ALL EXISTING WET UTILITIES. A MINIMUM 1' OF VERTICAL CLEARANCE IS NEEDED FROM ALL DRY UTILITIES.
- 3 INSTALL 8" GATE VALVE WITH VALVE BOX AND COVER (MAG STANDARD DETAIL NO. 391-2).
- 4 INSTALL FIRE HYDRANT COMPLETE (MAG STANDARD DETAIL NO. 360-1). INSTALL PAVEMENT MARKERS PER CITY OF BUCKEYE STANDARD DETAIL NO. 31440.
- 5 CONNECT TO BUILDING FIRE PROTECTION SYSTEM WITH NECESSARY AND APPROPRIATE FITTINGS. SEE FIRE PROTECTION AND PLUMBING DRAWINGS FOR EXACT LOCATION AND CONTINUATION.
- 6 INSTALL 6" DUCTILE IRON (PRESSURE CLASS 350) WATER LINE. TRENCHING SHALL BE PER CITY OF BUCKEYE STANDARD DETAIL NO. 31380.
- 7 INSTALL 6" GATE VALVE WITH VALVE BOX AND COVER (MAG STANDARD DETAIL NO. 391-2).
- 8 INSTALL 8" X 8" TAPPING SLEEVE AND 8" GATE VALVE (MAG STANDARD DETAIL NOS. 340 AND 391-2). FIELD VERIFY ELEVATION AND LOCATION PRIOR TO CONSTRUCTION.
- 9 INSTALL 8" TEE.
- 10 INSTALL 8" X 8" X 6" TEE.
- 11 INSTALL 8" - 90° BEND.
- 12 INSTALL 8" - 45° BEND.
- 13 INSTALL 6" P.V.C. (AWWA C-900, DR-18, PRESSURE CLASS 235) WATER LINE WITH DUCTILE IRON BENDS, FITTINGS, CONCRETE THRUST BLOCKS, ETC.
- 14 EXISTING WATER LINE & ASSOCIATED GATE VALVE TO BE REMOVED BETWEEN THE LIMITS INDICATED.
- 15 INSTALL 6" - 90° BEND.
- 16 SAWCUT, REMOVE AND REPLACE EXISTING CONCRETE SIDEWALK TO THE NEAREST JOINT (MAG STANDARD DETAIL NO. 230). SCORING AND FINISH TO MATCH EXISTING.
- 17 CAP EXISTING WATER LINE WITH A WATERTIGHT CAP AND THRUST BLOCK. FIELD VERIFY ELEVATION AND LOCATION PRIOR TO CONSTRUCTION.
- 18 SAWCUT, REMOVE AND REPLACE EXISTING A.C. PAVEMENT (MAG STANDARD DETAIL NO. 200, T-TOP AND CITY OF BUCKEYE STANDARD DETAIL NO. 31380).
- 19 REMOVE EXISTING REDUCER AND GATE VALVE. CONNECT TO EXISTING 8" WATER LINE WITH A NEW 45° BEND.
- 20 SAWCUT, REMOVE AND REPLACE EXISTING CONCRETE VERTICAL CURB AND GUTTER TO THE NEAREST JOINT (MAG STANDARD DETAIL NO. 220-1, TYPE A).
- 21 CONNECT TO EXISTING HYDRANT WITH NECESSARY AND APPROPRIATE FITTINGS. READJUST EXISTING FIRE HYDRANT AS NEEDED TO MAKE THE CONNECTION.
- 22 SAWCUT, REMOVE AND REPLACE EXISTING CONCRETE SINGLE CURB TO THE NEAREST JOINT (MAG STANDARD DETAIL NO. 222, TYPE 'A').
- 23 INSTALL 8" TO 6" REDUCER.

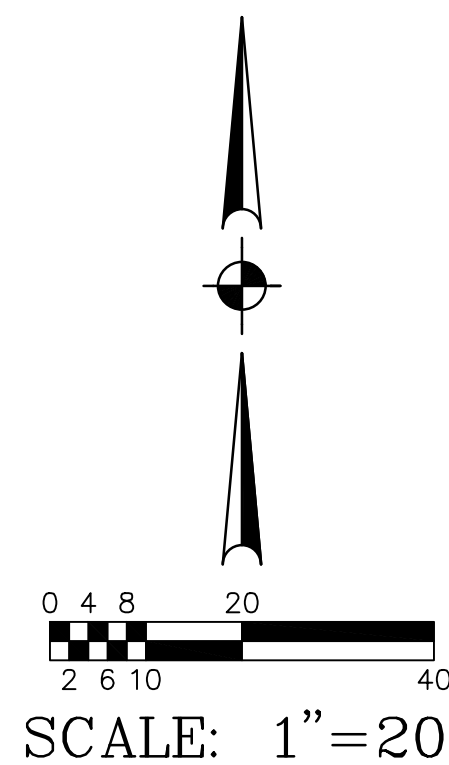

Liberty Transportation Center

Permit/GMP Documents  
07.02.24  
REVISIONS

ASI 01 07/01/24 MARICOPA CO. COMMENTS

30-22131-01

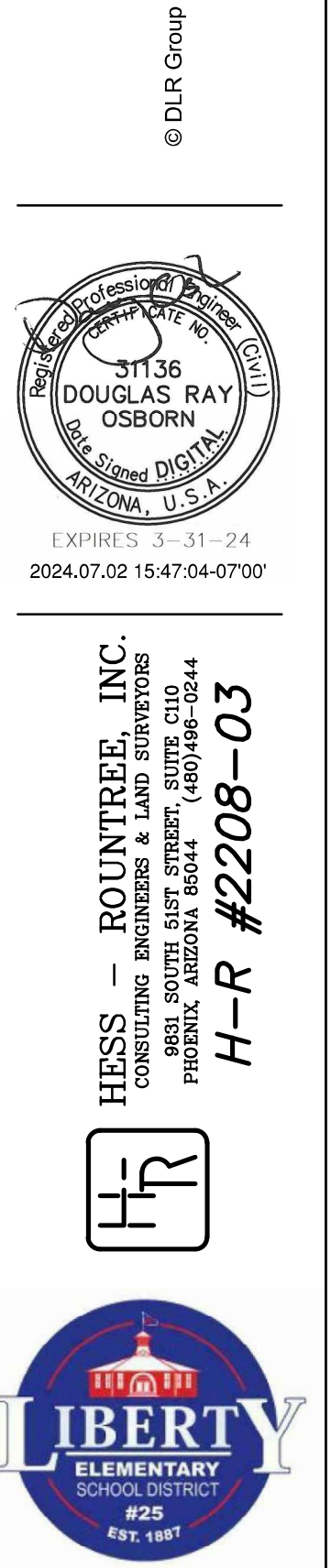



## GENERAL ABBREVIATIONS

# & @	NUMBER AND AT
ADA	AMERICANS WITH DISABILITY ACT
ADDN	ADDITION OR ADDITIONAL
AFF	ABOVE FINISHED FLOOR
AFG	ABOVE FINISHED GRADE
AHJ	AUTHORITY HAVING JURISDICTION
ALT	ALTERNATE
ANSI	AMERICAN NATIONAL STANDARDS INSTITUTE
APPROX	APPROXIMATE
ARCH	ARCHITECTURAL
BLDG	BUILDING
BSMT	BASEMENT
CL	CENTER LINE
CLG	CEILING
CM	CENTIMETER
CONC	CONCRETE
CONN(S)	CONNECTION(S)
CONST	CONSTRUCTION
CONT	CONTINUOUS
CONTR	CONTRACTOR
CTR	CENTER
D	DEPTH
DEG	DEGREE
DEMO	DEMOLISH OR DEMOLITION
DIA	DIAMETER
DIM	DIMENSION
DIV	SPECIFICATION DIVISION
DN	DOWN
DTL	DETAIL
DWG(S)	DRAWING(S)
E	EAST
EA	EACH
EC	ELECTRICAL CONTRACTOR
EL	ELEVATION
ELEC	ELECTRICAL
ENG	ENGINEER
EQ	EQUAL
EQUIP	EQUIPMENT
EQUIV	EQUIVALENT
EXST	EXISTING
EXT	EXTERIOR
FIN	FINISHED
FL	FLOOR
FT	FEET
FUT	FUTURE
GC	GENERAL CONTRACTOR
GOVT	GOVERNMENT
H	HEIGHT
HORIZ	HORIZONTAL
HT	HEIGHT
i.e.	THAT IS
IBC	INTERNATIONAL BUILDING CODE
IN	INCH
INT	INTERIOR
LB(S)	POUND(S)
M	METER
MAX	MAXIMUM
MC	MECHANICAL CONTRACTOR
MECH	MECHANICAL
MEZZ	MEZZANINE
MFR	MANUFACTURER
MIN	MINIMUM
MISC	MISCELLANEOUS
MM	MILLIMETER
N	NORTH
N/A	NOT APPLICABLE
NIC	NOT IN CONTRACT
NTS	NOT TO SCALE
OC	ON CENTER
OPP	OPPOSITE
OVHD	OVERHEAD
PAR	PARALLEL
PENT	PENTHOUSE
PLYWD	PLYWOOD
QTY	QUANTITY
REQ(D)	REQUIRE(D)
REV	REVISION(S)
RM	ROOM
RND	ROUND
S	SOUTH
SCHED	SCHEDULE
SECT	SECTION
SHT	SHEET
SIM	SIMILAR
SPEC	SPECIFICATION(S)
STD	STANDARD
STL	STEEL
STOR	STORAGE
STRUCT	STRUCTURAL
SYM	SYMMETRICAL
TEMP	TEMPORARY
TYP	TYPICAL
UNEX	UNEXCAVATED
UNFIN	UNFINISHED
UNO	UNLESS NOTED OTHERWISE
VERT	VERTICAL
VEST	VESTIBULE
VIF	VERIFY IN FIELD
W	WEST
W/	WITH
W/O	WITHOUT

## GENERAL SYMBOLS

	DETAIL NUMBER CROSS REFERENCE SHEET NUMBER		EARTH
	BUILDING ELEVATION		GRAVEL
	INTERIOR ELEVATION		SAND
	SIMILAR OR TYPICAL REFERENCE		CONCRETE
	DETAIL REFERENCE		PRECAST CONCRETE
	BUILDING SECTION		STEEL
	SHEET NOTE		STONE
	REFERENCE KEYNOTE		CONCRETE MASONRY UNIT
	COLUMN GRID LINE		BRICK VENEER
	ROOM NAME		GYM FLOOR
	REVISION NUMBER		WOOD (CONTINUOUS BLOCKING)
	LEVEL ELEVATION		WOOD (NON-CONTINUOUS BLOCKING)
	FINISH FLOOR ELEVATION		WOOD (TRIM/FINISH)
	SPOT ELEVATION		GLASS
			SHINGLES
			PLYWOOD (LARGE SCALE)
			GYPSUM WALL BOARD
			BLANKET INSULATION
			RIGID INSULATION
			SPRAY FOAM INSULATION
			MINERAL WOOL INSULATION
			PROTECTION BOARD
			CARPET (LARGE SCALE)
			ACOUSTIC TILE (LARGE SCALE)
			TILE (LARGE SCALE)

### IRRIGATION EASEMENT WORK.

LIBERTY WAS REQUIRED TO PAY FOR THE INSTALLATION OF THE NEW IRRIGATION LINE BY BWDD AS PART OF THE WORK TO IMPROVE THIS PARCEL.

BWDD DID NOT PROVIDE PLANS. THIS WAS DESIGNED AND INSTALLED BY BWDD AS WAS OUTSIDE OF THE LIBERTY ESD PROPOERTY LINE.

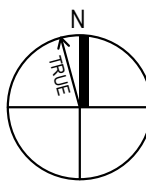

Existing Site  
SCALE: 1" = 20'-0"

## GENERAL NOTES

- GENERAL NOTES APPLY TO ALL SHEETS.
- DIMENSIONS ARE ACTUAL AND ARE TO FACE OF STUDS, FACE OF CONCRETE WALLS, FACE OF CMU WALLS, FACE OF FRAMES, OR CENTERLINE OF COLUMNS, UNLESS NOTED OTHERWISE.
- COORDINATE WITH MECHANICAL AND ELECTRICAL CONTRACTORS THE SIZE AND LOCATION OF EQUIPMENT PADS SHOWN ON PLANS.
- CONSTRUCTION DOCUMENTS ARE COMPLEMENTARY. SEE DRAWING FOR QUANTITIES AND LOCATION OF WORK. SEE SPECIFICATIONS FOR QUALITIES AND CONDITIONS OF WORK.
- WORK: ALL ASPECTS OF THE WORK AND ITEMS NOT SPECIFICALLY MENTIONED, BUT NECESSARY TO MAKE A COMPLETE WORKING INSTALLATION, SHALL BE INCLUDED AND INDICATED IN THE CONTRACTOR'S BID.
- GENERAL SHEET NOTES ONLY APPLY TO PARTICULAR DRAWING OR SERIES OF DRAWINGS.
- NO ASBESTOS OR PCB CONTAINING MATERIALS SHALL BE USED ON THIS PROJECT.
- DO NOT SCALE DRAWINGS. DIMENSIONS NOTED PREVAIL. NOTIFY ARCHITECT IN CASE OF DISCREPANCY.
- HORIZONTAL AND VERTICAL DIMENSIONS ARE MINIMUM DIMENSIONS. CLEARANCES ARE GIVEN TO FINISH SURFACES. GC TO VERIFY ALL CLEARANCES. NOTIFY ARCHITECT IN CASE OF DISCREPANCY.

PARCELS 502-55-029P, 502-55-029K, 502-55-014B, 502-55-029N AND 502-55-029M WILL BE COMBINED AND ANNEXED INTO THE CITY OF BUCKEYE. THE DISTRICT IS CONCURRENTLY WORKING WITH THE CITY OF BUCKEYE ON THIS PROCESS, WHICH WILL FOLLOW THE CONSTRUCTION PERMITS PROCUREMENT. THIS HAS BEEN ADDRESSED IN THE CITY OF BUCKEYE (COB) PAC SUMMARY PAC # PL2M-24-005 DATED FEBRUARY 8, 2024. COB IS DEFERRING THIS LOT COMBINATION AND ANNEXATION TO A FUTURE PHASE OF THE DEVELOPMENT.



GENERAL DEMOLITION NOTES:

- EXISTING STRUCTURES, MATERIALS, LANDSCAPING, ETC., THAT ARE TO REMAIN, WHICH ARE DAMAGED IN THE PERFORMANCE OF THE WORK, ARE THE CONTRACTOR'S RESPONSIBILITY TO REPAIR OR REPLACE IN KIND. THE ENGINEER AND OWNER SHALL BE THE JUDGE OF ACCEPTABILITY OF REPAIR OR REPLACEMENT.
- ALL NON-SALVAGE ITEMS SHALL BE REMOVED FROM THE SITE AND DISPOSED OF LEGALLY.
- SECURITY AND SAFETY ARE THE CONTRACTOR'S SOLE RESPONSIBILITY.
- SAWCUT SIDEWALKS AND CONCRETE AT NEAREST JOINT OR AS DIRECTED BY THE ENGINEER OR THE CITY INSPECTOR.
- SAWCUT ASPHALTIC CONCRETE AT LIMITS OF DEMOLITION AS SHOWN ON PLANS OR AS DIRECTED BY THE ENGINEER OR THE CITY INSPECTOR.
- SALVAGE ITEMS NOT BEING REINSTALLED SHALL BE DELIVERED TO THE DISTRICT MAINTENANCE YARD.
- THE CONTRACTOR MUST PERFORM ALL CLEARING, DEMOLITION REMOVALS AND SITE PREPARATIONS NECESSARY FOR THE EXECUTION OF THE WORK AND CONTAINED IN THE CONTRACT DOCUMENTS.

- THE CONTRACTOR MUST VERIFY THE LOCATIONS OF ALL UTILITIES, STRUCTURES, AND SERVICES BEFORE COMMENCING WORK. CONTRACTOR IS RESPONSIBLE FOR POT HOLING AND UTILITY SURVEY AS NECESSARY TO LOCATE EXISTING UTILITIES.
- THE CONTRACTOR MUST PROTECT IN PLACE ALL EXISTING UTILITIES UNLESS OTHERWISE NOTED.

SPECIFIC DEMOLITION NOTES:

- WITHIN DEMOLITION AREA, REMOVE AND LEGALLY DISPOSE OF ALL BUILDINGS, CONCRETE, ASPHALT, A.B.C., CONCRETE SIDEWALKS, WALLS, CURBS, DRIVEWAY, TREES AND ANY IMPROVEMENTS EXCEPT ITEMS NOTED TO REMAIN AND BE PROTECTED OR TO BE REMOVED AND SALVAGED. ALL UTILITIES ARE TO REMAIN IN PLACE AND BE PROTECTED FROM DAMAGE UNLESS OTHERWISE NOTED.
- EXISTING CONCRETE IRRIGATION DITCH TO BE REMOVED BY CONTRACTOR AND PIPED UNDERGROUND BY BUCKEYE WATER CONSERVATION DRAINAGE DISTRICT (BWCCD).
- EXISTING BUILDINGS, ASSOCIATED IMPROVEMENTS AND UTILITIES TO REMAIN DURING PHASE 1. PROTECT FROM DAMAGE.
- EXISTING CONCRETE IRRIGATION DITCH TO BE ABANDONED IN PLACE. COORDINATE WITH BWCCD.
- EXISTING PIPE FROM THE IRRIGATION DITCH TO BE CAPPED PER BWCCD REQUIREMENTS.

BWCCD DID NOT PROVIDE PLANS. THIS WAS DESIGNED AND INSTALLED BY BWCCD AS WAS OUTSIDE OF THE LIBERTY ESD PROPOERTY LINE.

A.P.N. 502-55-029Q  
TGV INVESTMENTS LLC

LIMITS OF DEMOLITION

LIMITS OF DEMOLITION

LIMITS OF DEMOLITION

MATCH

SHEET

C-6

Autodesk Docs://30-22131-01 Liberty ESD Transportation Facility/30-22131-01\_Liberty ESD Transportation Site\_AR\_2022.rvt  
1/30/2024 11:27:35 AM

© DLR Group



HSSS - ROUNTREE, INC.  
CONSULTING ENGINEERS & LAND SURVEYORS  
9831 SOUTH 51ST STREET, SUITE C110  
PHOENIX, ARIZONA 85044 (480)486-0844  
H-R #2208-03

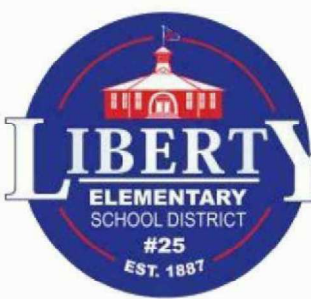
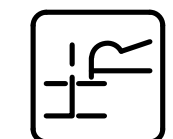

Liberty Transportation Center

Permit/GMP Documents  
07.02.24  
REVISIONS

ASI 01 07/01/24 MARICOPA CO. COMMENTS

30-22131-01  
PARTIAL TOPOGRAPHIC SURVEY AND DEMOLITION PLAN

5 OF 17  
C-5

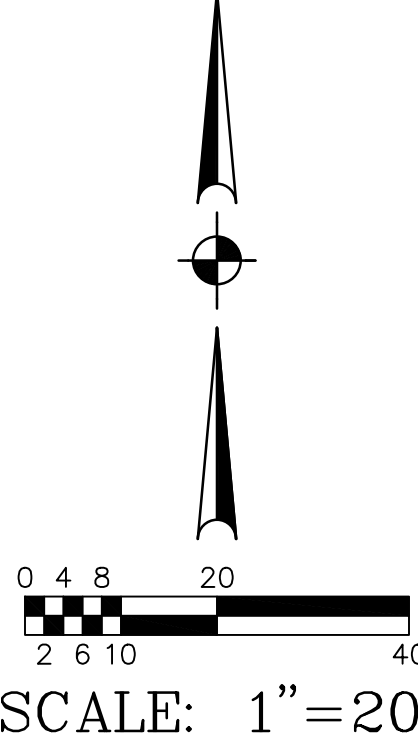



1. WITHIN DEMOLITION AREA, REMOVE AND LEGALLY DISPOSE OF ALL BUILDINGS, CONCRETE, ASPHALT, A.B.C., CONCRETE SIDEWALKS, WALLS, CURBS, DRIVEWAY, TREES AND ANY IMPROVEMENTS EXCEPT ITEMS NOTED TO REMAIN AND BE PROTECTED OR TO BE REMOVED AND SALVAGED. ALL UTILITIES ARE TO REMAIN IN PLACE AND BE PROTECTED FROM DAMAGE UNLESS OTHERWISE NOTED.
2. EXISTING CONCRETE IRRIGATION DITCH TO BE REMOVED BY CONTRACTOR AND PIPED UNDERGROUND BY BUCKEYE WATER CONSERVATION DRAINAGE DISTRICT (BWCD).
3. EXISTING BUILDINGS, ASSOCIATED IMPROVEMENTS AND UTILITIES TO REMAIN DURING PHASE 1. PROTECT FROM DAMAGE.
4. EXISTING CONCRETE IRRIGATION DITCH TO BE ABANDONED IN PLACE. COORDINATE WITH BWCD.
5. EXISTING PIPE FROM THE IRRIGATION DITCH TO BE CAPPED PER BWCD REQUIREMENTS.

**C-6**

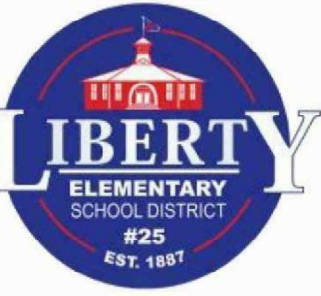



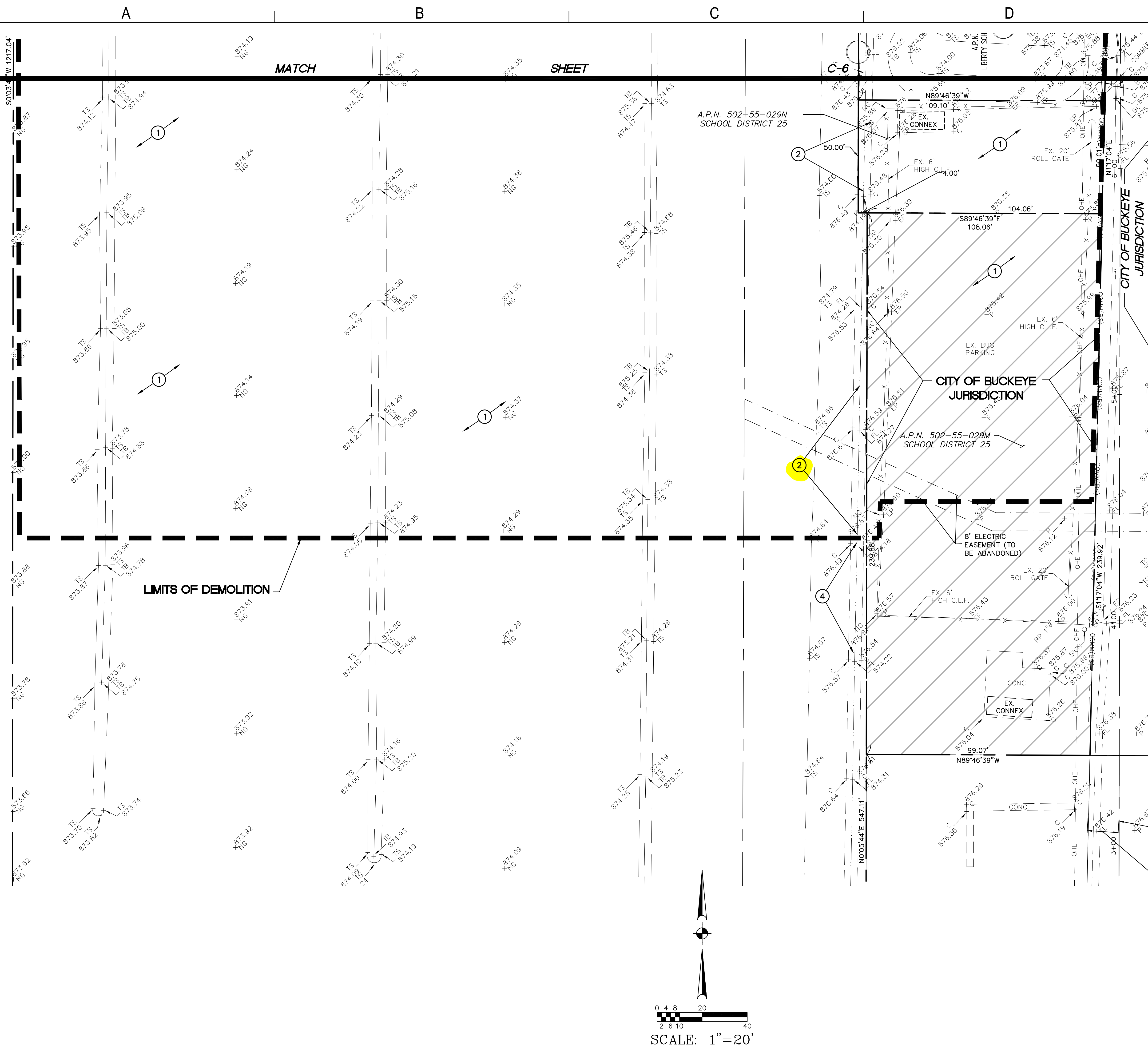

#### GENERAL DEMOLITION NOTES:

- EXISTING STRUCTURES, MATERIALS, LANDSCAPING, ETC., THAT ARE TO REMAIN, WHICH ARE DAMAGED IN THE PERFORMANCE OF THE WORK, ARE THE CONTRACTOR'S RESPONSIBILITY TO REPAIR OR REPLACE IN KIND. THE ENGINEER AND OWNER SHALL BE THE JUDGE OF ACCEPTABILITY OF REPAIR OR REPLACEMENT.
- ALL NON-SALVAGE ITEMS SHALL BE REMOVED FROM THE SITE AND DISPOSED OF LEGALLY.
- SECURITY AND SAFETY ARE THE CONTRACTOR'S SOLE RESPONSIBILITY.
- SAWCUT SIDEWALKS AND CONCRETE AT NEAREST JOINT OR AS DIRECTED BY THE ENGINEER OR THE CITY INSPECTOR.
- SAWCUT ASPHALTIC CONCRETE AT LIMITS OF DEMOLITION AS SHOWN ON PLANS OR AS DIRECTED BY THE ENGINEER OR THE CITY INSPECTOR.
- SALVAGE ITEMS NOT BEING REINSTALLED SHALL BE DELIVERED TO THE DISTRICT MAINTENANCE YARD.
- THE CONTRACTOR MUST PERFORM ALL CLEARING, DEMOLITION REMOVALS AND SITE PREPARATIONS NECESSARY FOR THE EXECUTION OF THE WORK AND CONTAINED IN THE CONTRACT DOCUMENTS.
- THE CONTRACTOR MUST VERIFY THE LOCATIONS OF ALL UTILITIES, STRUCTURES, AND SERVICES BEFORE COMMENCING WORK. CONTRACTOR IS RESPONSIBLE FOR POT HOLING AND UTILITY SURVEY AS NECESSARY TO LOCATE EXISTING UTILITIES.
- THE CONTRACTOR MUST PROTECT IN PLACE ALL EXISTING UTILITIES UNLESS OTHERWISE NOTED.

#### SPECIFIC DEMOLITION NOTES:

- WITHIN DEMOLITION AREA, REMOVE AND LEGALLY DISPOSE OF ALL BUILDINGS, CONCRETE, ASPHALT, A.B.C., CONCRETE SIDEWALKS, WALLS, CURBS, DRIVEWAY, TREES AND ANY IMPROVEMENTS EXCEPT ITEMS NOTED TO REMAIN AND BE PROTECTED OR TO BE REMOVED AND SALVAGED. ALL UTILITIES ARE TO REMAIN IN PLACE AND BE PROTECTED FROM DAMAGE UNLESS OTHERWISE NOTED.
- EXISTING CONCRETE IRRIGATION DITCH TO BE REMOVED BY CONTRACTOR AND PIPED UNDERGROUND BY BUCKEYE WATER CONSERVATION DRAINAGE DISTRICT (BWCD).
- EXISTING BUILDINGS, ASSOCIATED IMPROVEMENTS AND UTILITIES TO REMAIN DURING PHASE 1. PROTECT FROM DAMAGE.
- EXISTING CONCRETE IRRIGATION DITCH TO BE ABANDONED IN PLACE. COORDINATE WITH BWCD.
- EXISTING PIPE FROM THE IRRIGATION DITCH TO BE CAPPED PER BWCD REQUIREMENTS.

BWCD DID NOT PROVIDE PLANS. THIS WAS DESIGNED AND INSTALLED BY BWCD AS WAS OUTSIDE OF THE LIBERTY ESD PROPERTY LINE.

Liberty Transportation Center

Permit/GMP Documents  
07.02.24  
REVISIONS

ASI 01 07/01/24 MARICOPA CO. COMMENTS

30-22131-01  
PARTIAL TOPOGRAPHIC SURVEY AND DEMOLITION PLAN

7 OF 17  
C-7

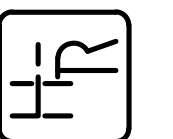
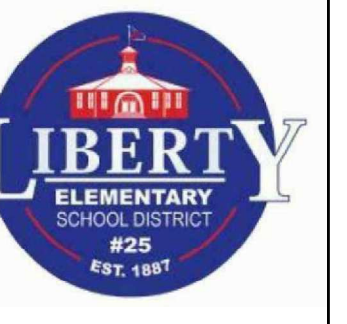

HPS - ROUNTREE, INC.  
CONSULTING ENGINEERS & LAND SURVEYORS  
9831 SOUTH 51ST STREET, SUITE C10  
PHOENIX, ARIZONA 85044 (480)498-0244  
H-R #2208-03

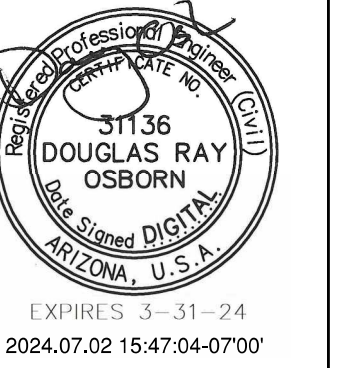

© DLR Group

